



jordanfishwick

Peter Street
£850 PCM



Peter Street, Cheshire, SK11 8ET **£850 PCM**



The Property

AVAILABLE MID DECEMBER PART FURNISHED

Located on this popular road is this two bedroom mid terrace.

This attractive terrace is competitively priced and is sure to appeal to the professional couple or growing family, being within walking distance of Macclesfield town centre and the train station along with gas central heating and a communal courtyard.

Lounge, fitted dining kitchen with gas hob and electric oven, fridge freezer, washing machine and dryer. To the first floor two well-proportioned bedrooms and bathroom with shower over bath.

Communal rear yard, On road parking and gas central heating.

Directions

Leaving Macclesfield along Park Lane, continue through traffic lights at the junction with Bond Street and then Peter Street is the second turning on the right. The property will be found on the left hand side.

Contact Macclesfield 01625 502222. £850.00pcm

COUNCIL TAX B

EPC C

Directions

SK11 8ET

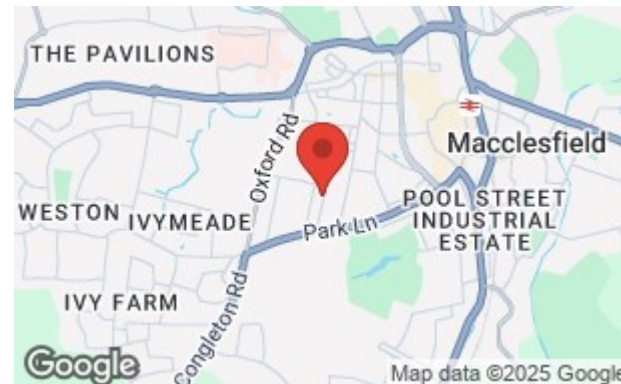

- TWO BEDROOMS
- POPULAR ROAD
- WALKING DISTANCE OF TOWN CENTRE
- COMMUNAL REAR YARD
- COUNCIL TAX B
- EPC C

Postcode - SK11 8ET

EPC Rating - C

Floor Area - sq ft

Local Authority - Cheshire East Council

Council Tax - B



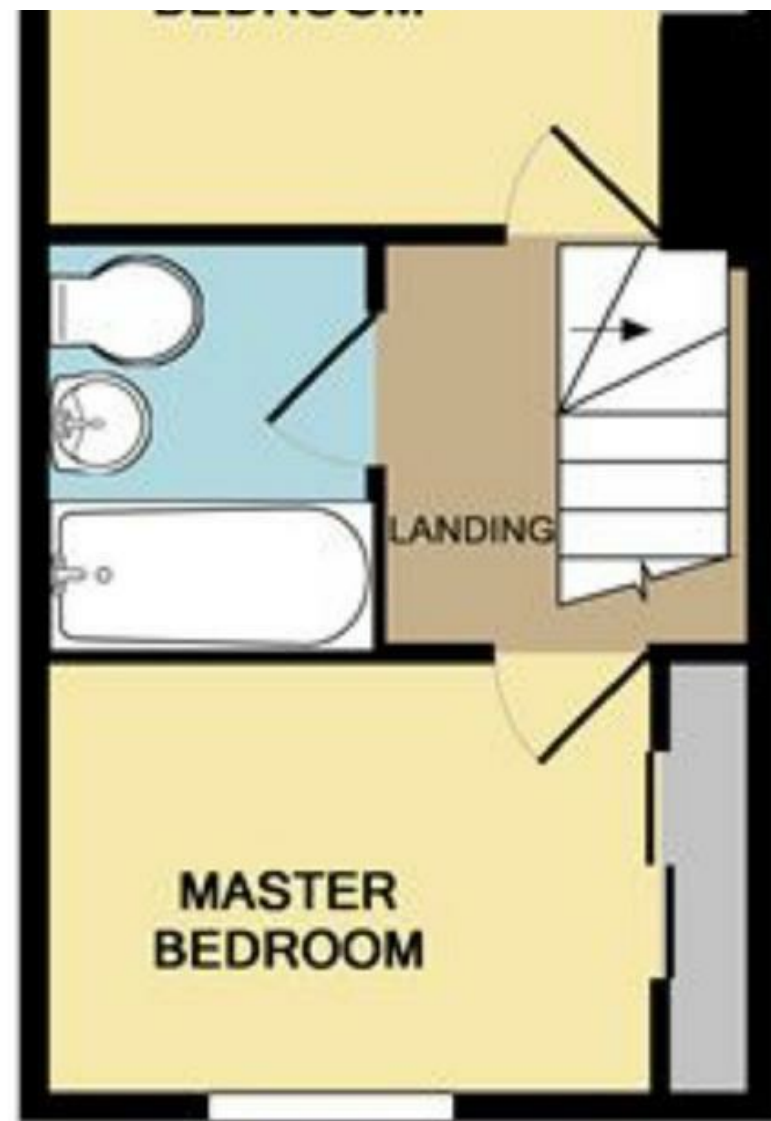
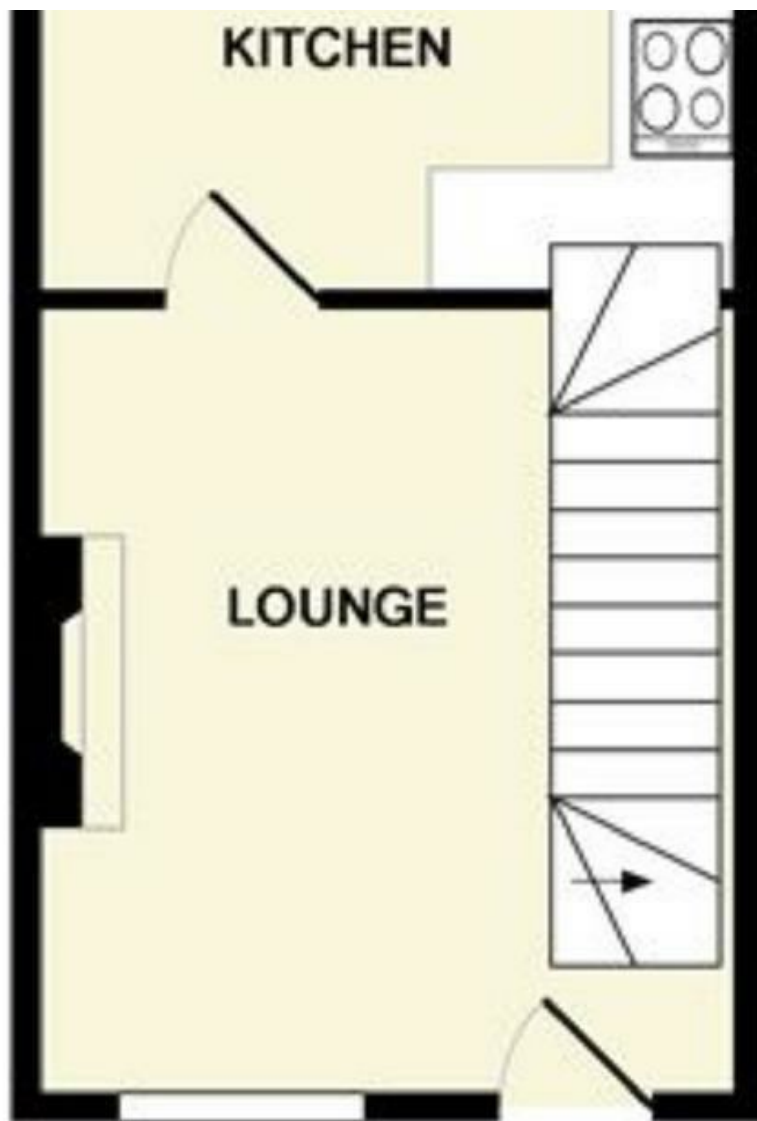

These particulars are believed to be accurate but they are not guaranteed and do not form a contract. Neither Jordan Fishwick nor the vendor or lessor accept any responsibility in respect of these particulars, which are not intended to be statements or representations of fact and any intending purchaser or lessee must satisfy himself by inspection or otherwise as to the correctness of each of the statements contained in these particulars. Any floorplans on this brochure are for illustrative purposes only and are not necessarily to scale.

Offices at: Chorlton, Didsbury, Disley, Hale, Glossop, Macclesfield, Manchester Deansgate, Manchester Whitworth Street, New Mills, Sale, Wilmslow and Withington

01625 502222